

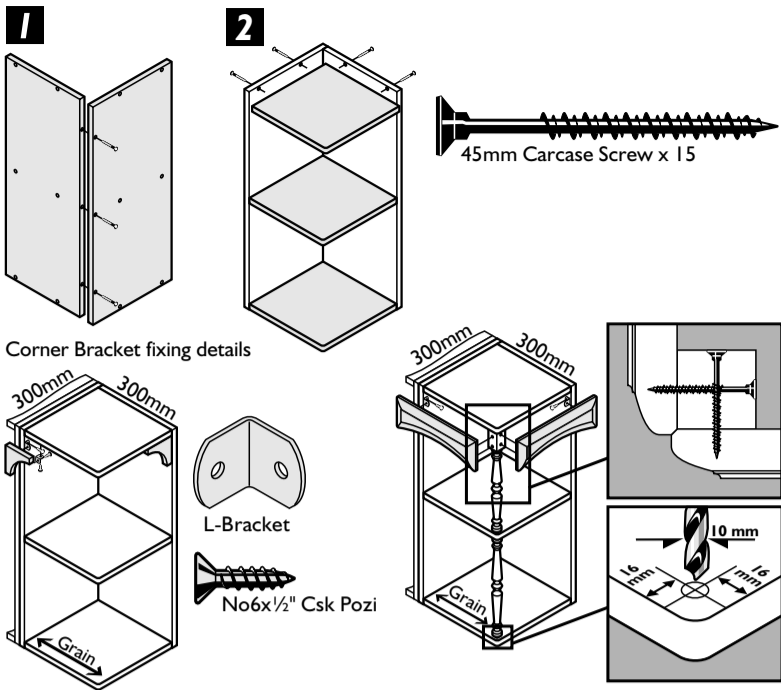

## Open End Wall Units

NOTE: Not all items are available in all ranges.



## 500 Dresser Unit

\*NOTE: The Unit can be fixed to the wall through the back panel and wall fixing rail.

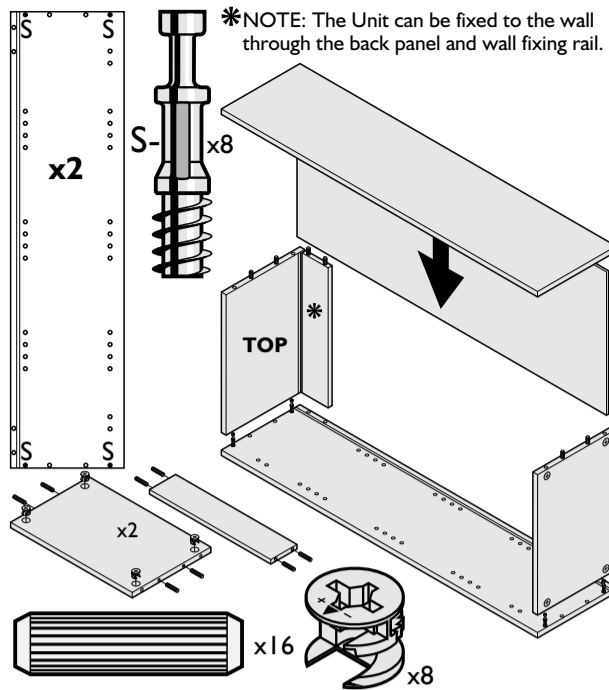

## 500 Open Unit

\*NOTE: The Unit can be fixed to the wall through the back panel and wall fixing rail.

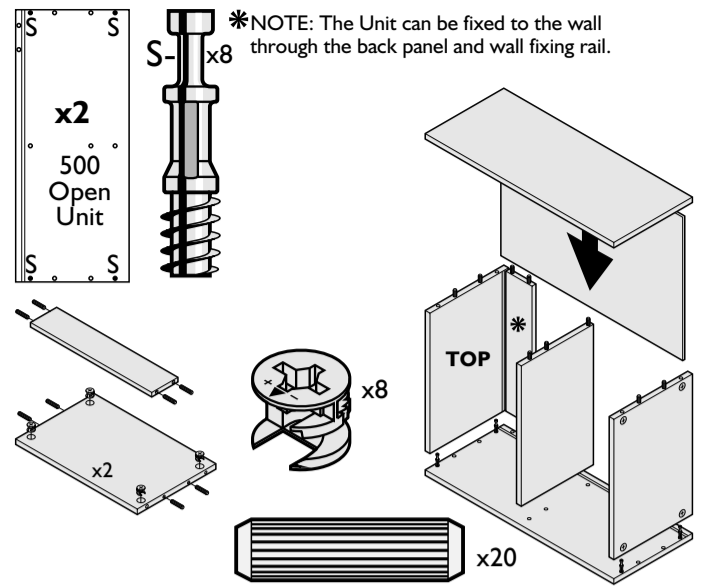

## Installation

-Standard Units are hung on Wall Hanging Brackets which should be securely fastened to the wall with suitable fixings. If a Larder or Dresser Unit is being used, the position of the Wall Hanging Bracket is measured down from the top of these units. Refer to the illustration for dimensions.

-All Standard Units and most Decor Units and Accessories should be fastened together by using No.8 x 1 1/4" Csk Pozi Screws.

-Fixings can be concealed under hinge plates, drawer runners etc.

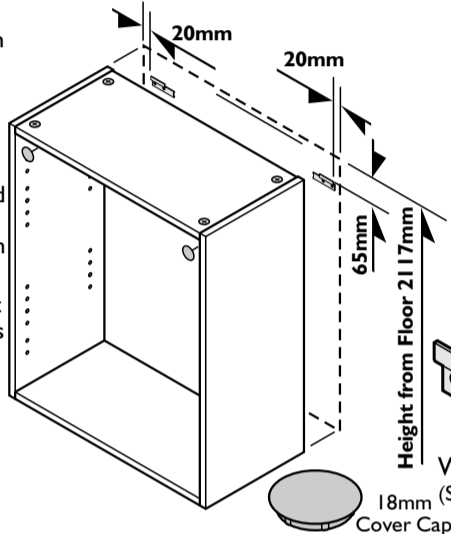

## Wall Hanging Bracket Adjustments

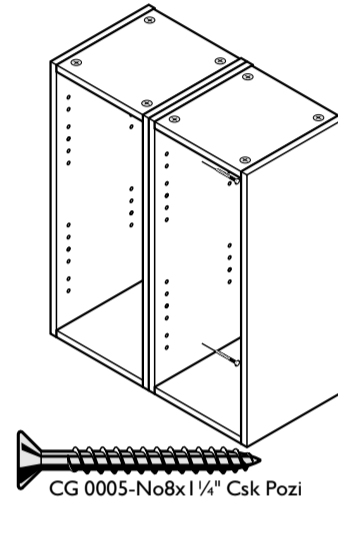
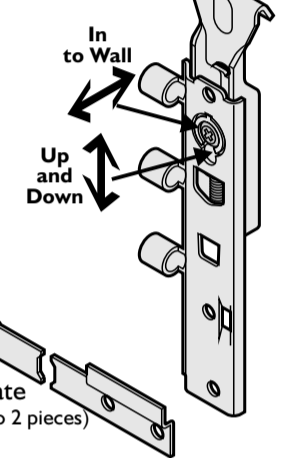

## Hinges Doors & Shelves

-Put the hinge and hinge plate together before fitting to the door as this makes finding the mounting holes in the end panels easy. The 110° and 170° Hinge are fitted and adjusted the same way.

-The door on single door units can open either left or right. Attach the hinges to one side of the door only.

-Put the shelf into position with 2 shelf peg inserts and retainers in the front holes and 2 rear shelf pegs into the back holes.

-Fit an anti-tip support into the hole at the back one space above the shelf.

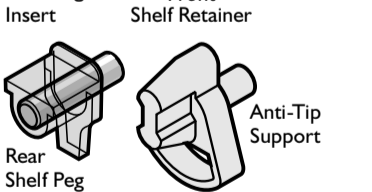
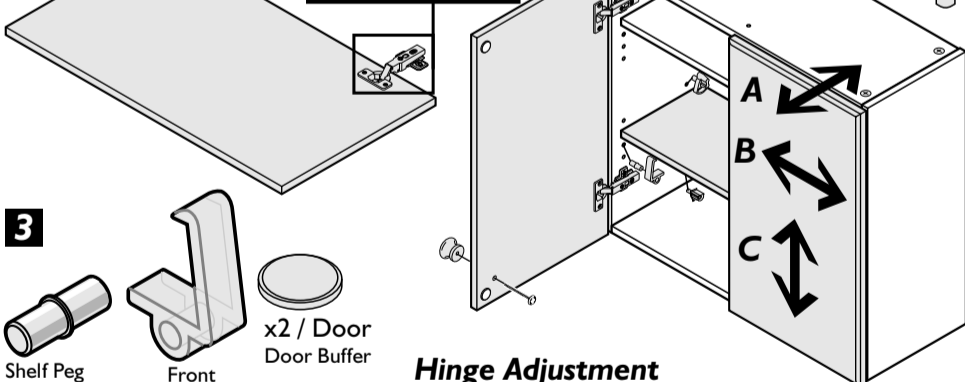
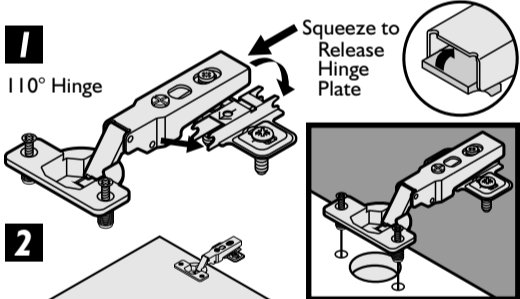

## Hinge Adjustment

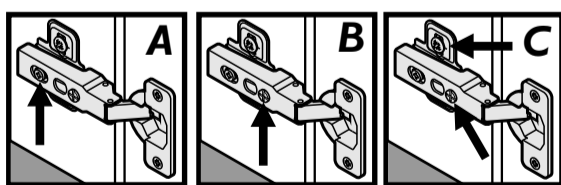

## L-Shaped Corner Unit

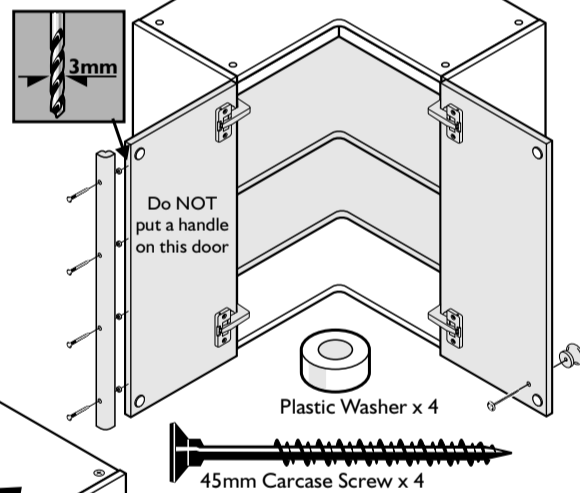

## Bridging Unit (900mm Unit has centre divider)

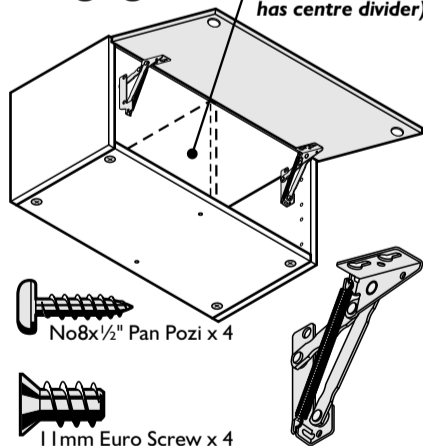

## Add-on End Panel & Divider

Add-on panels and dividers are designed to project 25mm in front of the carcass edge and 62mm below the Unit. This gives a 'fitted door' appearance and the Light Pelmet is butted up to the Add-on Panel. Fix the add-on panel and dividers from inside the unit with No.6x1" screws. The screws can be concealed behind the hinge plates, drawer runners etc.

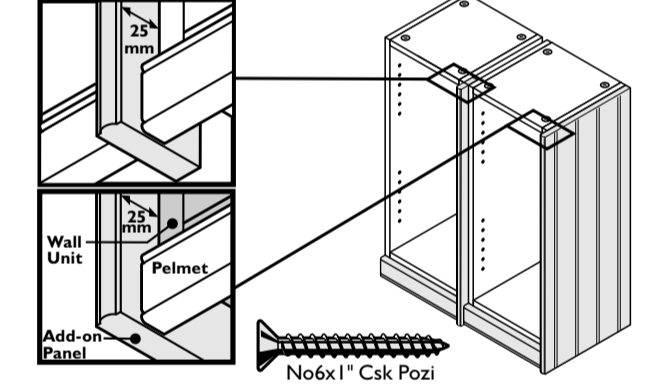

## Pilaster Fixing

NOTE: The Pilaster needs to be cut down to a height of 782mm for wall use. Trim the bottom part only. BETWEEN UNITS- Screw through from the adjoining units using No.6x1" screws. Screws can be concealed under hinge plates, drawer runners etc.

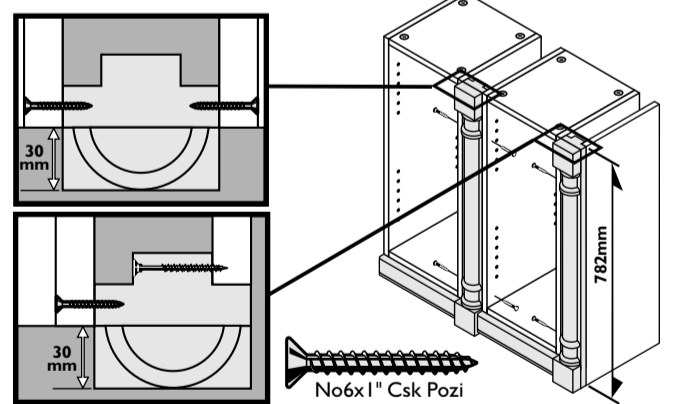

AT THE END OF A RUN OF UNITS- Use an End Support Panel cut to the size required. Screw through the Pilaster into the End Support Panel using suitable screws and through into the Pilaster from the adjoining unit using No.6x1" screws. Fix to the wall with a suitable block (not supplied)

## Light Pelmet Fixing

Along the front edge, fix the Light Pelmet flush with the front of the Wall Units. On certain ranges the Light Pelmet should be pulled forward to be almost in line with the door.

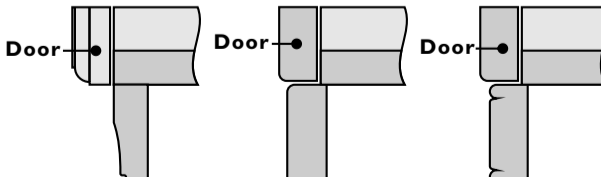

Where the Light Pelmet returns along the side of a Wall Unit, the Light Pelmet should always be flush with the End Panel.

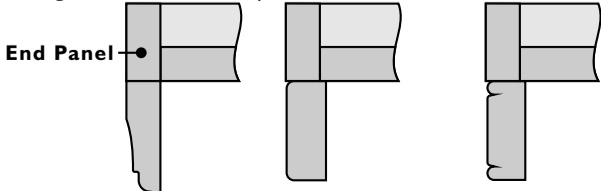

## Cornice Fixing

Along the front edge, overhang the door by lining the back of the rebate on the Cornice with the front edge of the unit.

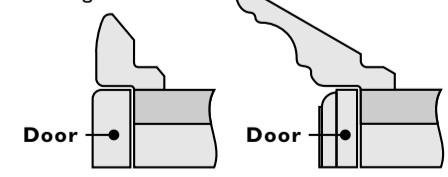

Where the Cornice returns along the side of a Wall Unit or Tall Unit, the rebate on the Cornice does not overhang the end panel.

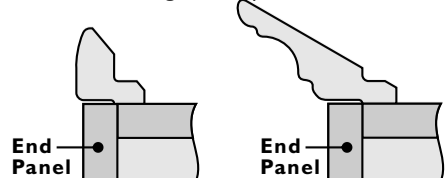

## Corner Bracket

The Corner Bracket Frieze is fitted into the corners of open units - two brackets.

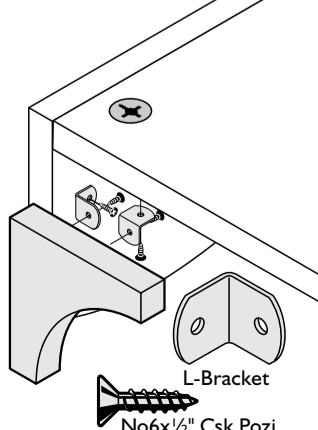

## Plate Rack & Lattice Wine Rack

The two dowels indicated are removed by lifting until they are clear at the bottom. The racks must be installed with the deeper hole in the top rail.

